

Greenwich & Charlton

# News Shopper

50p where sold

newsshopper.co.uk

Wednesday December 27, 2006



**WIN £500 TO SPEND ON YOUR BATHROOM**

Turn to Page 22

**HAPPY NEW YEAR**

Wishing all our loyal readers and valued advertisers a healthy and wealthy 2007



# WHARF TO BE DEMOLISHED

Site will provide 'stunning' new destination



Work to demolish Borthwick Wharf has already begun

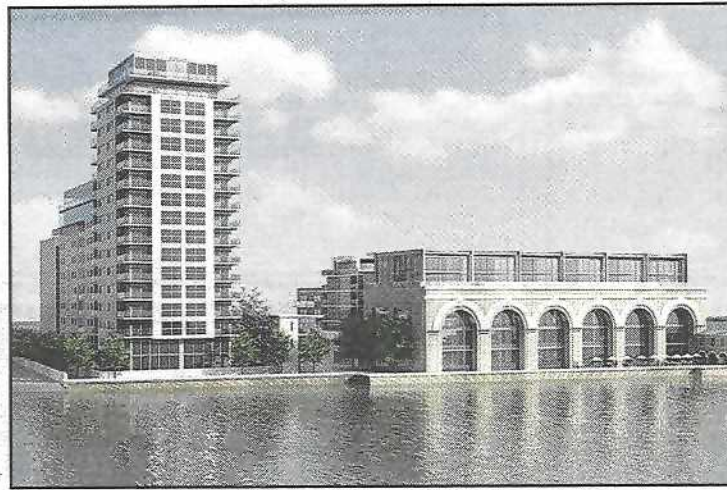

An artist's impression of how the new development will look

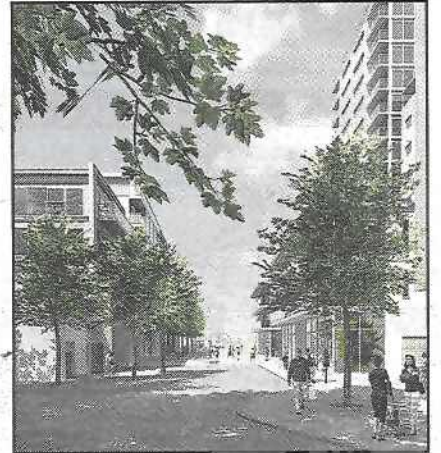

How the site will look

by SAMANTHA PAYNE

spayne@london.newsquest.co.uk

A NEW £45m housing development is set to turn a historic wharf into a "stunning new cultural destination"

Plans to demolish Borthwick Wharf and alter Paynes Wharf in Deptford to allow 247 riverview flats to be built have been approved by Greenwich Council's planning board.

The 18-storey block will also include a retail area with a restaurant, a gallery and office space.

Earlier this year, there was a temporary delay to the plans when the council agreed to quash its planning permission for the development.

This happened after a claim the planning board chairman had breached the rules.

According to the Creekside Forum, Councillor Maureen O'Mara broke the code of conduct at a planning meeting in January for failing to tell members she belonged to the Twinkle Park Trust.

The trust favoured the application and was earmarked to receive £10,000 as part of an agreement between former developer George Wimpey and the council.

Anyone with prejudicial interests in an application should inform other members to prevent an unlawful decision being made.

Cllr O'Mara did not declare her interest verbally but her involvement was recorded in the planning board agenda.

In January Bill Ellson, who represents the Creekside Forum, applied for a judicial review to get the application quashed by the High Court based on Cllr O'Mara's role at the meeting and other matters of concern.

And in August, the council agreed to do this, which meant the developer had to re-submit its application.

Now P&B Developments is looking forward to starting work on the scheme after it was voted through last week by the planning board at Woolwich Town Hall, Wellington Street, Woolwich.

P&B Developments director Mark O'Grady said: "We are delighted after many months of hard work and consul-

tation to have won permission to put our development proposals into action.

"Paynes and Borthwick wharves have the potential to become a stunning new cultural destination within a very short time."

Construction work on the new scheme is due to start in spring next year and be completed by spring 2009.

The demolition of Borthwick Wharf is already being carried out — to the disappointment of Mr Ellson.

He said: "We think the proposed tower block is terrible. It'll be an ugly stump which will stand by itself."

"We're disappointed it's been passed through."

But Eltham north councillor Dermot Poston, who voted the scheme through on December 21, said: "I think it's tremendous and I very much support it."

"It will open up the river for people who don't live there as there is a road through the scheme and one around it to access the river."

"It's one of the best-designed developments I have judged on the planning board."



Bill Ellson



Cllr Maureen O'Mara

Ford Fiesta & Vauxhall Corsa  
**AUTOMATICS**

The Ideal Small Cars For Today's Congested Roads!



If you find driving on our busy, Greater London roads somewhat frustrating, a Ford Fiesta or Vauxhall Corsa Automatic might be the answer to your problems. They're great for ripping around in and, with their excellent visibility, they really are a piece of cake to park. Yet, despite their size, they will easily carry 5 people and your shopping!

Most Cars Have: • Air conditioning • Central Locking • Electric windows • Multiple Airbags • Power Steering & Much, Much More!

Huge Choice of one owner cars with low mileage and full service history from just **£4999**

**Premier**

184-214 BLACKFEN ROAD • BLACKFEN • NR SIDCUP

TEL: **0845 124 4950**

(Number charged at local rate)

No other website even comes close, log on to [newsshopper.co.uk](http://newsshopper.co.uk) right now for even more news, views, features and sport